

Our Contact Finger Strips are available in a wide range of profiles, a choice of three materials and six finishes. There is also a choice of a conductive self-adhesive fixing or clip on.

They have a low closing force and do not take a compression set. They have long service life with good corrosion resistance.

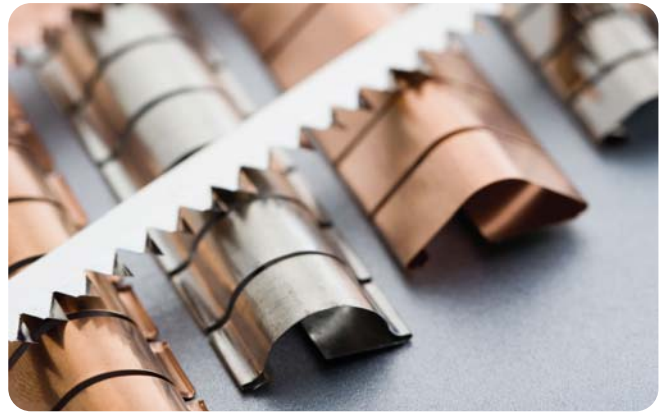

How to Order

Specify: Series-Style Number-Length-Material-Finish-Plating

Series	Style	Length	Material	Finish	Plating
CFS	See drawings	xxxx	CB=Beryllium Copper	S/A=Self Adhesive	Bd=Bright Finish
			CP=Phosphor Bronze	N/A=No Adhesive	Sn=Bright Tin
			CS=Stainless Steel		Ni=Bright Nickel
					Ag=Silver
					Au=Gold

Example:

CFS-008-406.4-CB-S/A-Bd is Contact finger strip, style 008, 406.4mm long in beryllium copper with self-adhesive, bright finish

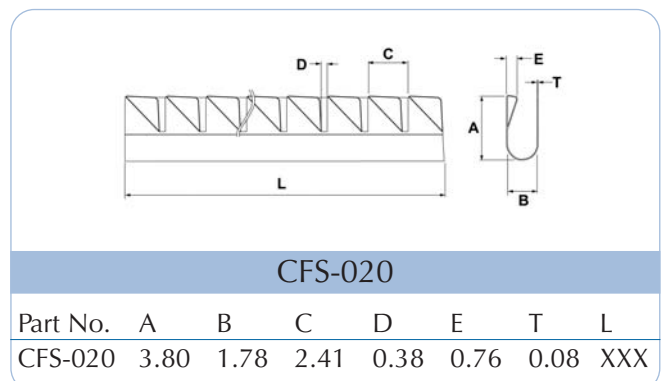
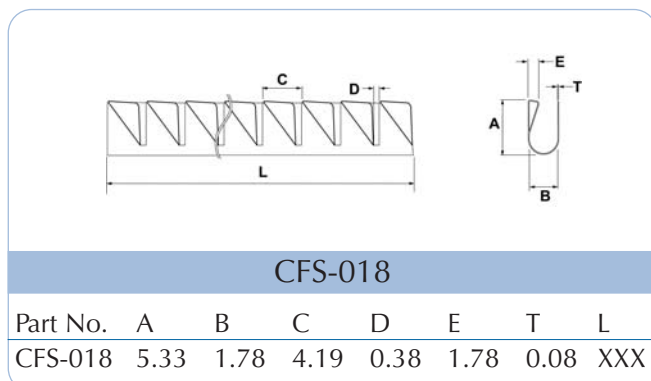
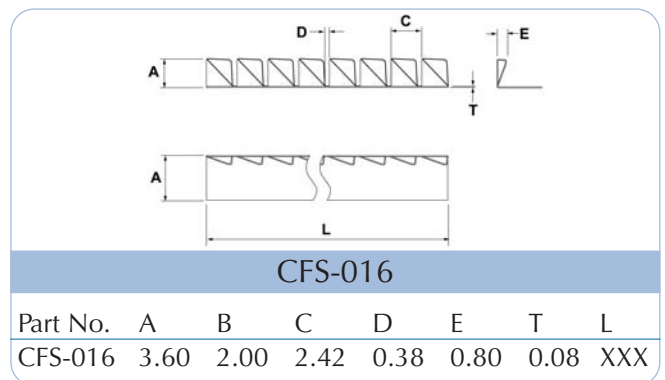
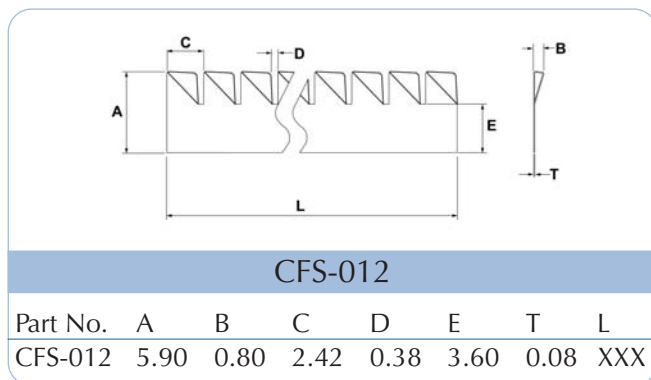
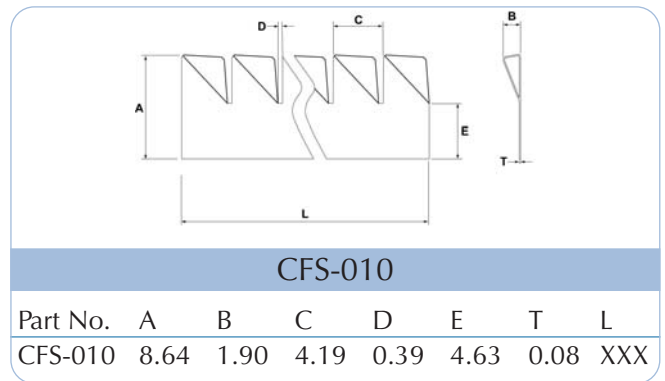
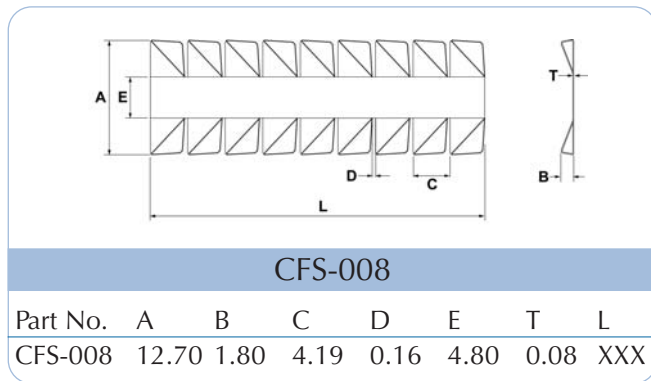

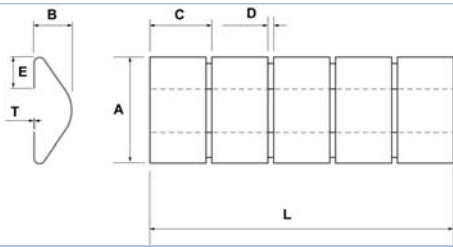

CFS-030

Part No.	A	B	C	D	E	T	L
CFS-030	8.13	2.79	4.75	0.46	2.16	0.08	XXX

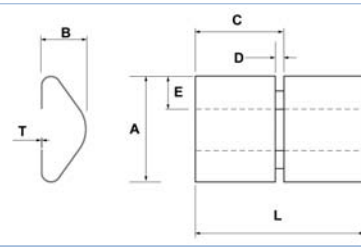

CFS-031

Part No.	A	B	C	D	E	T	L
CFS-031	7.87	3.05	6.35	0.50	2.28	0.08	XXX

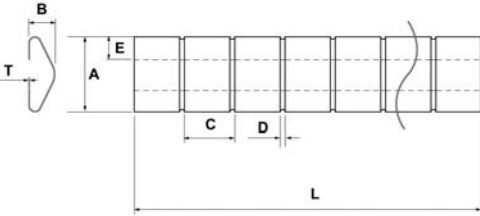

CFS-032

Part No.	A	B	C	D	E	T	L
CFS-032	9.40	3.30	6.35	0.63	2.16	0.08	XXX

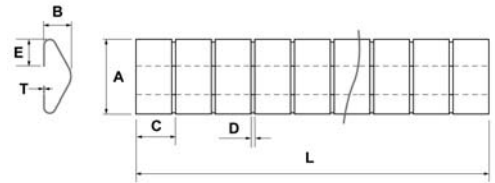

CFS-033

Part No.	A	B	C	D	E	T	L
CFS-033	8.90	3.20	4.75	0.46	3.20	0.08	XXX

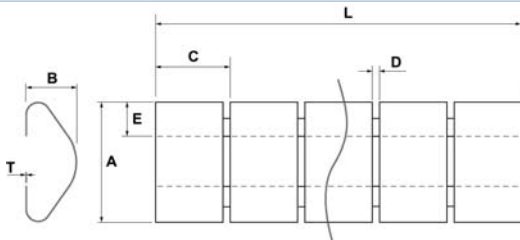

CFS-035

Part No.	A	B	C	D	E	T	L
CFS-035	7.60	3.30	4.75	0.43	2.10	0.08	XXX

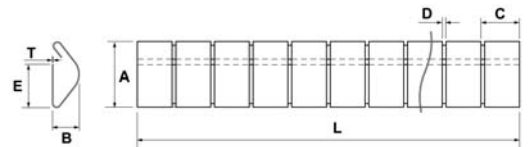

CFS-036

Part No.	A	B	C	D	E	T	L
CFS-036	8.10	2.80	4.70	0.46	5.30	0.08	XXX

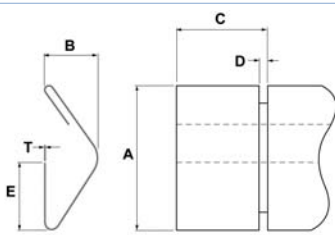

CFS-037

Part No.	A	B	C	D	E	T	L
CFS-037	15.20	5.60	9.50	0.80	7.10	0.08	XXX

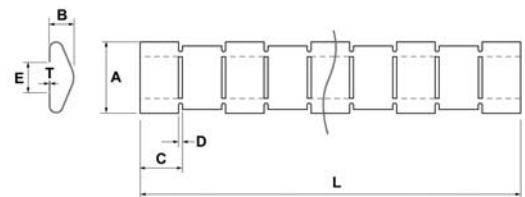

CFS-038

Part No.	A	B	C	D	E	T	L
CFS-038	8.12	2.80	4.76	0.46	4.10	0.08	XXX

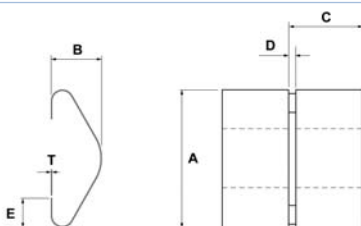

CFS-039

Part No.	A	B	C	D	E	T	L
CFS-039	8.90	2.80	4.75	0.46	3.40	0.08	XXX

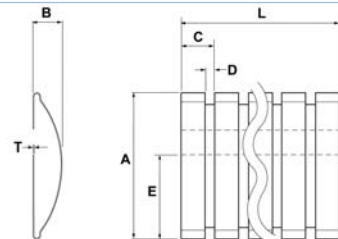

CFS-040

Part No.	A	B	C	D	E	T	L
CFS-040	15.21	3.09	3.18	0.64	8.30	0.08	XXX

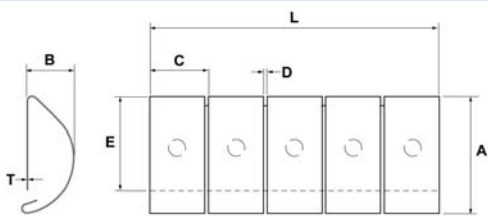

CFS-041

Part No.	A	B	C	D	E	T	L
CFS-041	25.90	10.10	12.70	1.00	20.40	0.08	XXX

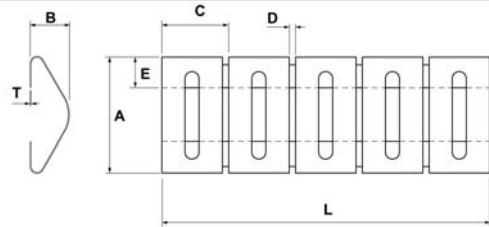

CFS-042

Part No.	A	B	C	D	E	T	L
CFS-042	8.25	2.57	4.75	0.46	2.16	0.08	XXX

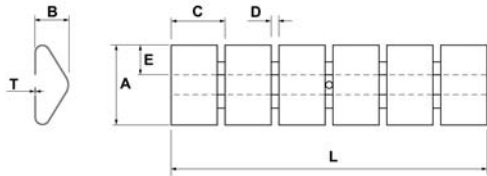

CFS-043

Part No.	A	B	C	D	E	T	L
CFS-043	5.00	2.00	3.20	0.50	1.60	0.08	XXX

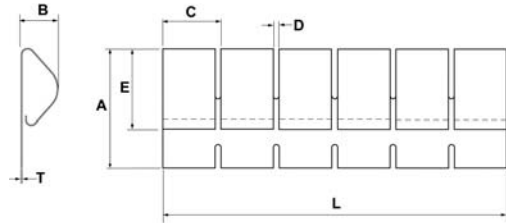

CFS-044

Part No.	A	B	C	D	E	T	L
CFS-044	12.70	3.30	6.50	0.50	8.72	0.08	XXX

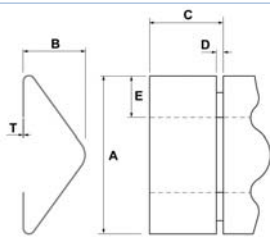

CFS-045

Part No.	A	B	C	D	E	T	L
CFS-045	20.30	8.10	9.52	0.81	5.31	0.08	XXX

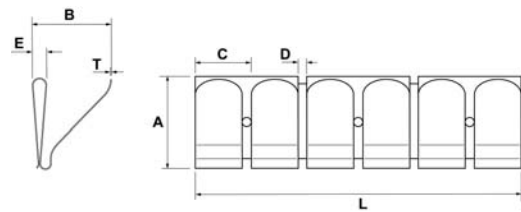

CFS-046

Part No.	A	B	C	D	E	T	L
CFS-046	9.70	8.64	6.35	1.00	1.60	1.10	XXX

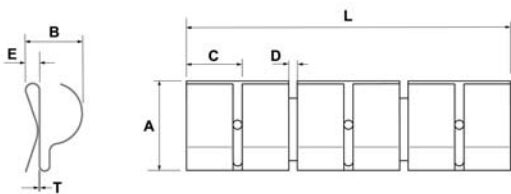

CFS-047

Part No.	A	B	C	D	E	T	L
CFS-047	9.70	5.10	6.35	1.02	1.80	0.10	XXX

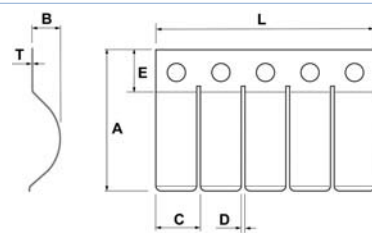

CFS-048

Part No.	A	B	C	D	E	T	L
CFS-048	27.70	6.30	9.53	1.02	6.00	0.08	XXX

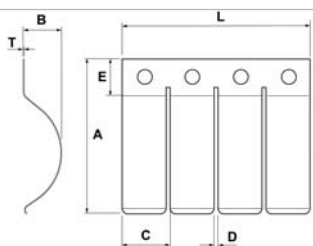

CFS-049

Part No.	A	B	C	D	E	T	L
CFS-049	41.40	10.40	12.70	1.02	8.00	0.08	XXX

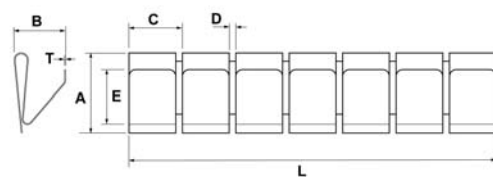

CFS-050

Part No.	A	B	C	D	E	T	L
CFS-050	9.50	4.15	5.94	0.35	4.80	0.15	XXX

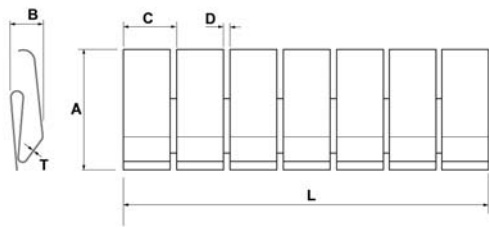

CFS-051

Part No.	A	B	C	D	E	T	L
CFS-051	13.80	6.35	6.35	0.76	-	0.10	XXX

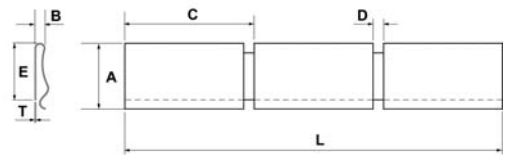

CFS-052

Part No.	A	B	C	D	E	T	L
CFS-052	6.33	1.45	13.84	1.14	6.05	0.10	XXX

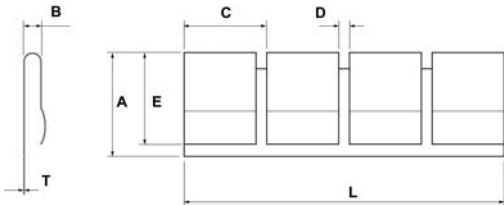

CFS-054

Part No.	A	B	C	D	E	T	L
CFS-054	6.40	1.80	5.10	0.76	5.40	0.08	XXX

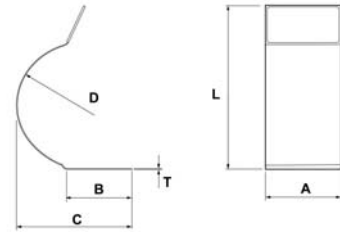

CFS-055

Part No.	A	B	C	D	E	T	L
CFS-055	42.50	7.30	12.98	7.00	-	0.08	XXX

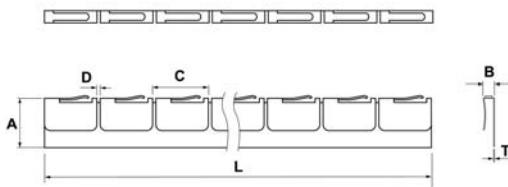

CFS-056

Part No.	A	B	C	D	E	T	L
CFS-056	4.64	1.62	7.62	0.51	-	0.08	XXX

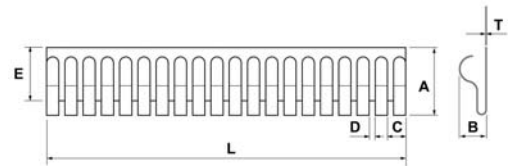

CBS-058

Part No.	A	B	C	D	E	T	L
CBS-058	6.90	2.80	1.90	0.64	5.60	0.15	XXX

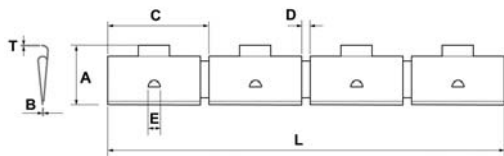

CFS-060

Part No.	A	B	C	D	E	T	L
CFS-060	7.75	0.25	13.84	1.14	2.03	0.10	XXX

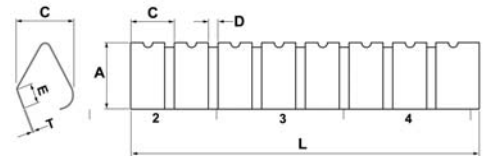

CFS-062

Part No.	A	B	C	D	E	T	L
CFS-062	6.60	5.80	4.78	1.19	1.60	0.08	XXX

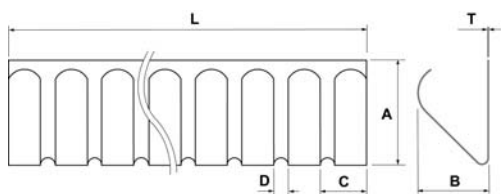

CFS-064

Part No.	A	B	C	D	E	T	L
CFS-064	5.80	5.10	3.40	1.02	2.04	0.25	XXX

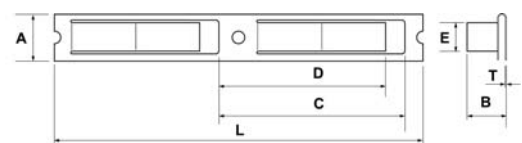

CFS-066

Part No.	A	B	C	D	E	T	L
CFS-066	7.49	6.24	29.20	26.30	4.44	0.10	XXX

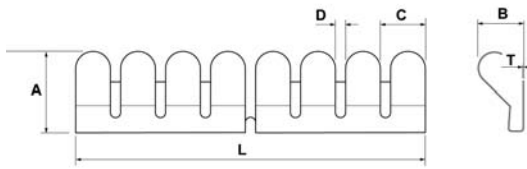

CFS-069

Part No.	A	B	C	D	E	T	L
CFS-069	7.80	3.30	4.62	1.18	-	0.10	XXX

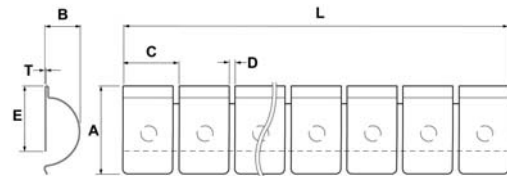

CFS-070

Part No.	A	B	C	D	E	T	L
CFS-070	7.10	2.80	4.78	0.46	5.80	0.08	XXX

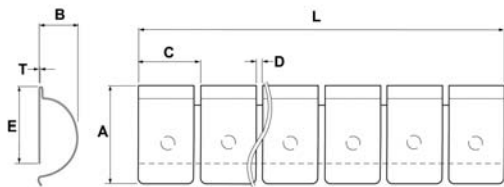

CFS-071

Part No.	A	B	C	D	E	T	L
CFS-071	9.40	3.60	6.35	0.56	7.90	0.08	XXX

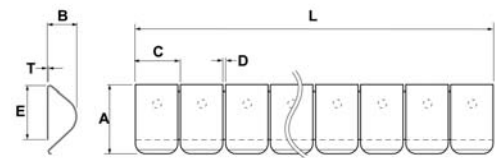

CFS-072

Part No.	A	B	C	D	E	T	L
CFS-072	15.20	5.80	9.53	0.80	12.70	0.10	XXX

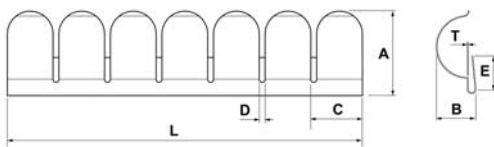

CFS-073

Part No.	A	B	C	D	E	T	L
CFS-073	6.20	3.00	6.32	0.72	4.70	0.10	XXX

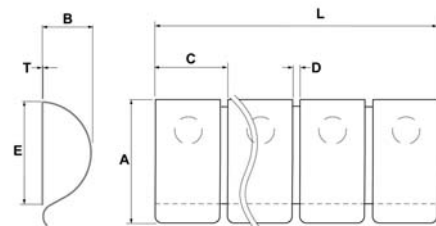

CFS-074

Part No.	A	B	C	D	E	T	L
CFS-074	17.00	7.90	9.53	1.02	13.50	0.10	XXX

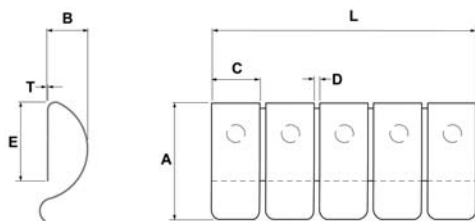

CFS-076

Part No.	A	B	C	D	E	T	L
CFS-076	19.80	6.40	9.35	1.02	13.50	0.10	XXX

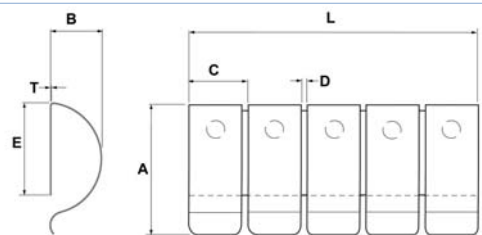

CFS-078

Part No.	A	B	C	D	E	T	L
CFS-078	28.70	10.40	12.70	1.02	19.80	0.18	XXX

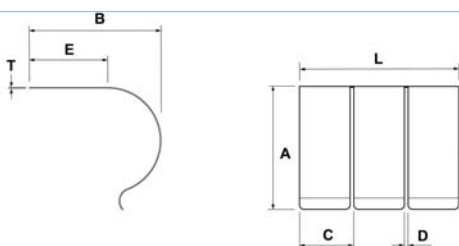

CFS-079

Part No.	A	B	C	D	E	T	L
CFS-079	29.42	29.22	12.70	1.02	19.05	0.10	XXX

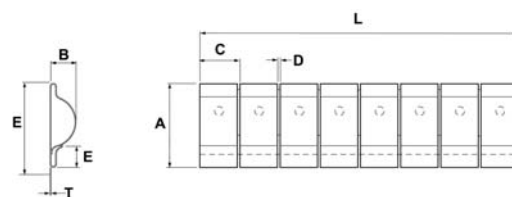

CFS-084

Part No.	A	B	C	D	E	T	L
CFS-084	13.00	3.60	6.35	0.56	3.30	0.08	XXX

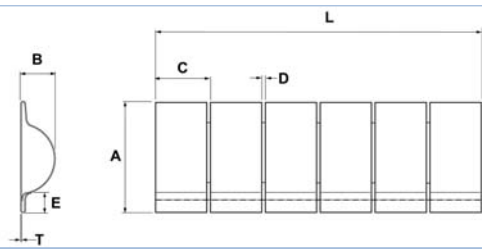

CFS-086

Part No.	A	B	C	D	E	T	L
CFS-086	19.30	5.80	9.53	0.80	3.38	0.10	XXX

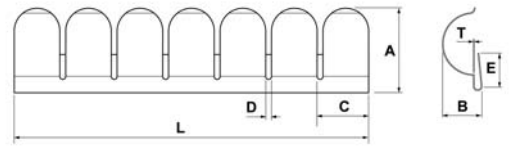

CFS-120

Part No.	A	B	C	D	E	T	L
CFS-120	12.50	3.90	4.66	1.20	5.00	0.10	XXX

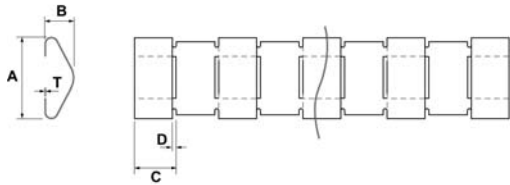

CFS-138

Part No.	A	B	C	D	E	T	L
CFS-138	9.40	3.30	4.76	0.45	-	0.08	XXX

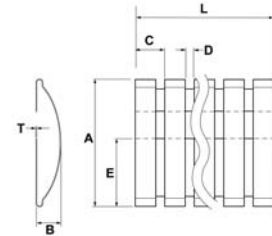

CFS-141

Part No.	A	B	C	D	E	T	L
CFS-141	15.20	3.70	3.18	0.64	8.30	0.08	XXX

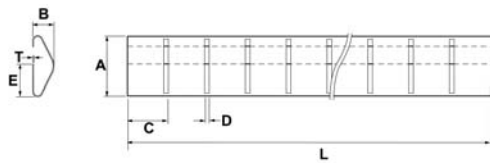

CFS-146

Part No.	A	B	C	D	E	T	L
CFS-146	9.40	3.30	6.35	0.62	25.00	0.08	XXX

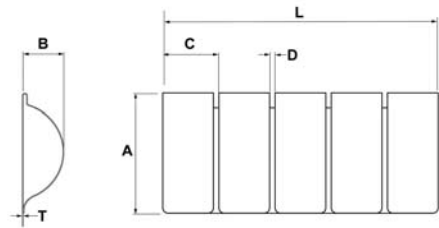

CFS-178

Part No.	A	B	C	D	E	T	L
CFS-178	20.00	7.00	9.40	1.00	-	0.08	XXX

